

ASSEMBLY INSTRUCTIONS

CVSSEZTB24 & CVSSEZTB36 - Clear Vinyl Banner Stand

V20.08

CAUTION: Before starting the assembly, wear gloves to protect your hands.



Connect tubes by matching the numbers on the ends.

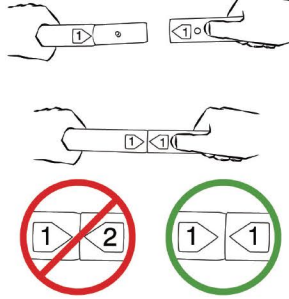

1. Snap and connect the side tubes as shown below. Connect the other side tube the same way.

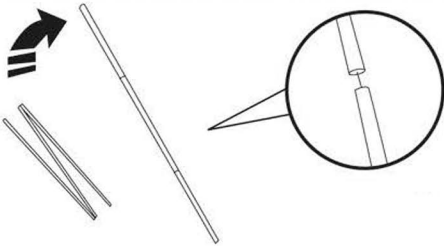
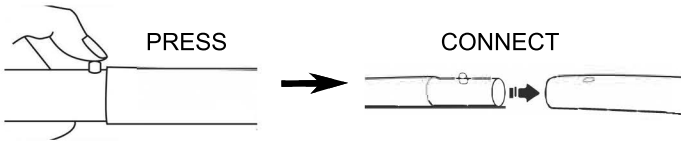

2. Insert 1 assembled side tube through the sleeve on one side of the clear vinyl. Do the same for the other side.

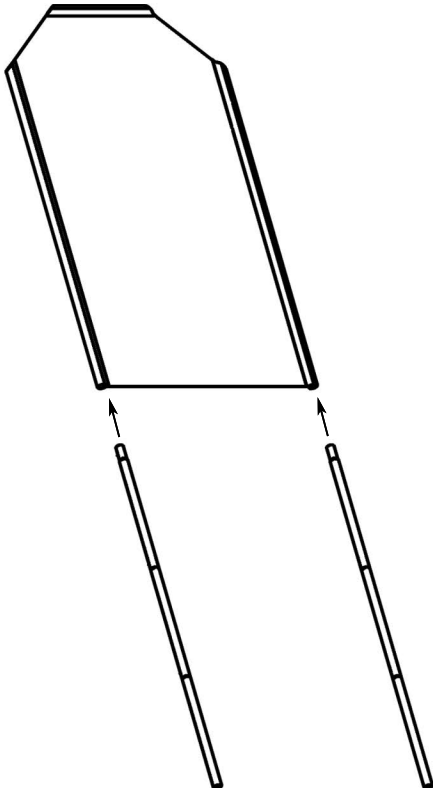

3. Insert the top tube into the top sleeve on the clear vinyl. Connect the corner tubes with the top tube by matching the numbers.

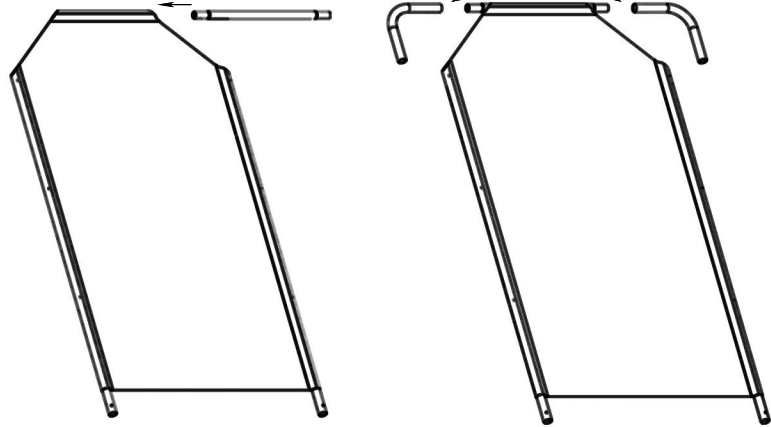

Connect the corner tubes with the side tubes by matching the numbers.

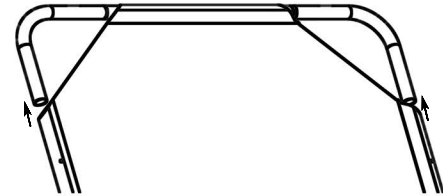

4. Carefully lift the assembled vinyl barrier up to its standing position. Snap and connect it to the base. The assembly is finished.



Scan QR code to visit the product page:



If you have any questions regarding our products, please visit us at www.displays2go.com or contact D2G customer service 844-221-3388.

DISPLAYS2GO